

# PSD 40x/41x



only with hollow shaft



| PSD 40x/41x | Nominal torque / Nominal rated speed <sup>1)</sup> | Self-holding torque (energized) | Max. speed            | Positioning range <sup>2)</sup> |
|-------------|--|---------------------------------|-----------------------|---------------------------------|
| 1-5V        | 0.8 Nm/200 min <sup>-1</sup>                       | 0.4 Nm                          | 800 min <sup>-1</sup> | 4026 rot.                       |
| 1-8H        | 0.8 Nm/200 min <sup>-1</sup>                       | 0.4 Nm                          | 500 min <sup>-1</sup> | 4026 rot.                       |
| 1-14H       | 0.8 Nm/200 min <sup>-1</sup>                       | 0.4 Nm                          | 500 min <sup>-1</sup> | 4026 rot.                       |
| 3-8H        | 3 Nm/ 50 min <sup>-1</sup>                         | 1.5 Nm                          | 250 min <sup>-1</sup> | 986 rot.                        |
| 3-14H       | 3 Nm/ 50 min <sup>-1</sup>                         | 1.5 Nm                          | 250 min <sup>-1</sup> | 986 rot.                        |

<sup>1)</sup> at nominal supply voltage

<sup>2)</sup> not subject to mechanical limits

|   |  |
|---|--|
| Mode of operation   | S1 <sup>3)</sup> , S3  |
| Supply voltage  | 24 VDC ± 10 %<br>galvanically separated between motor and control                          |
| Rated current   | 2.0 A  |
| Power consumption (control unit)                                | 0.1 A  |
| Positioning accuracy  | ± 0.7° for 3 Nm<br>± 1.8° for 0.8 Nm   |
| Absolute measurement system                                     | magnetic, without reference run, without buffer battery                                    |
| Shock resistance<br>in accordance with IEC/DIN EN 60068-2-27    | 50 g 11 ms<br>± 3 shocks pos./neg. per axis  |
| Vibration resistance<br>in accordance with IEC/DIN EN 60068-2-6 | 10..2000 Hz 50 m/s <sup>2</sup> (approx. 5 g)<br>10 frequency cycles                       |
| Output shaft  | 5 mm solid shaft with flattening or 8/14 mm hollow shaft <sup>4)</sup> with torque support |
| Max. axial force  | 15 N, 20 N with attached housing   |
| Max. radial force   | 40 N   |
| Ambient temperature   | 0..40 °C   |
| Storage temperature   | -10..70 °C   |
| Protection class  | IP 50 or IP 65 <sup>5)</sup>   |
| Housing   | Aluminum, Silicon steel, Zinc  |
| Weight  | max. 1 100 g<br>(800 g without gearbox)  |
| Certificates  | CE, opt.: NRTL   |

<sup>3)</sup> Use in continuous operation S1 must be checked depending on the application. Please contact our sales department for more information.

<sup>4)</sup> see table next to the characteristic curve

<sup>5)</sup> Shaft feed-through (solid shaft) IP50, for further information see instruction manual

PSD 401-5V (solid shaft)

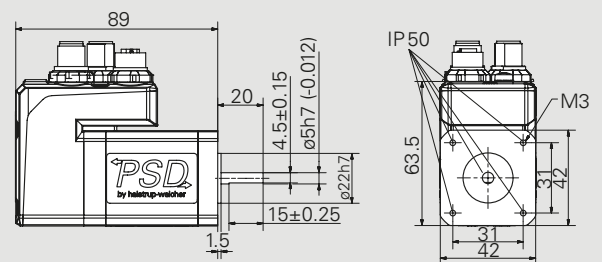

PSD 411-8 / 14H (hollow shaft, 0.8 Nm)

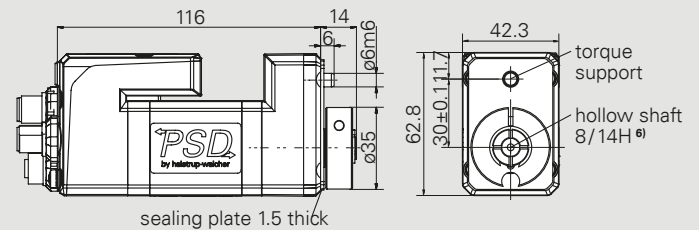



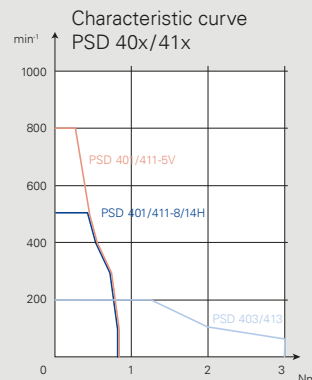
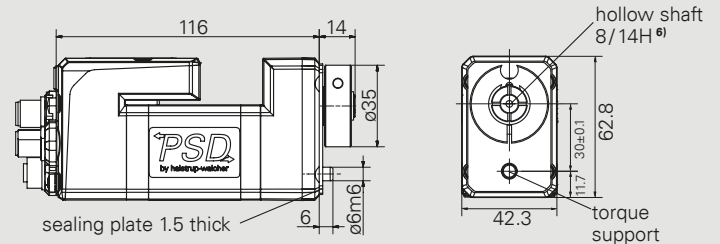

PSD 413-8 / 14H (hollow shaft, 3 Nm)



| <sup>6)</sup> Hollow shaft | ø8              | ø14 |
|----------------------------|-----------------|-----|
| Tolerance                  | H7              |     |
| Plug depth                 | 20              |     |
| Cylinder screw             | DIN 912 M4 x 16 |     |

Dimensions in mm

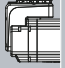
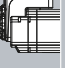
## Order code PSD 4 series

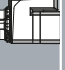
| Order code   | A   | B   | C   | D                         | E                                    | F   | G                     | H |
|--|---|---|---|---------------------------|--------------------------------------|---|-----------------------|---|
| PSD  |   |   |   |                           |                                      |   |                       |   |
| A  | B   | C   | D   | E                         | F                                    | G   | H                     |   |
| Type   | Torque/<br>Output shaft                           | Rotation shaft/<br>Housing                      | Bus<br>communication <sup>1)</sup>  | Electical<br>connections  | Protection<br>class                  | Software modules  | Certificates          |   |
|  40: horizontal   | 1-5V<br>1-8H<br>1-14H<br><br><b>with gearbox:</b> | S: direct or 0°<br>1: 90°<br>2: 180°<br>3: 270° | CA: CANopen<br>IO: IO-Link<br>PL: POWER-LINK <sup>5)</sup><br>PN: PROFINET<br>EC: EtherCAT<br>EI: EtherNet/IP | 0: standard <sup>2)</sup> | 50: IP 50<br>65: IP 65 <sup>3)</sup> | 1: standard<br>M: with modulo function <sup>4)</sup><br>S: with changeover of parameter set <sup>4)</sup><br>P: with target speed in process data <sup>4)</sup><br>Z: with modulo function and changeover of parameter set and target speed in process data <sup>4)</sup> | 0: CE<br>N: NRTL + CE |   |
|  41: vertical     | 3-8H<br>3-14H                                     |   |   |                           |                                      |   |                       |   |
|  42: horizontal   | 2-8V<br>2-8H<br>2-14H<br><br><b>with gearbox:</b> |   |   |                           |                                      |   |                       |   |
|  43: vertical    | 4-14H<br>6-14H<br>8-14H                           |   |   |                           |                                      |   |                       |   |
|  48: horizontal | 0-5V<br>0-8H<br>0-14H<br><br><b>with gearbox:</b> |   |   |                           |                                      |   |                       |   |
|  49: vertical   | 1-8H<br>1-14H                                     |   |   |                           |                                      |   |                       |   |

|              | B                       |                               | C  |   |   |   |   |
|--------------|-------------------------|-------------------------------|--|---|---|---|---|
|              | Key                     | Torque                        | Output shaft                                     | Rotation shaft/Housing  |   |   |   |
|              | B1-B2                   | B1                            | B2   | S   | 1   | 2   | 3   |
| direct       | 1-5V                    | 1: 0.8 Nm                     | 5V: 5 mm solid shaft                             |  | -   | -   | -   |
|              | 1-8H<br>1-14H           | 1: 0.8 Nm                     | 8H: 8 mm hollow shaft<br>14H: 14 mm hollow shaft |  |  |  |  |
| with gearbox | 3-8H<br>3-14H           | 3: 3 Nm                       | 8H: 8 mm hollow shaft<br>14H: 14 mm hollow shaft |  |  |  |  |
| direct       | 2-8V                    | 2: 2 Nm                       | 8V: 8 mm solid shaft                             |  | -   | -   | -   |
|              | 2-8H<br>2-14H           | 2: 2 Nm                       | 8H: 8 mm hollow shaft<br>14H: 14 mm hollow shaft |  |  |  |  |
| with gearbox | 4-14H<br>6-14H<br>8-14H | 4: 4 Nm<br>6: 6 Nm<br>8: 8 Nm | 14H: 14 mm hollow shaft                          |  |  |  |  |
| direct       | 0-5V                    | 0: 0.25 Nm                    | 5V: 5 mm solid shaft                             |  | -   | -   | -   |
|              | 0-8H<br>0-14H           | 0: 0.25 Nm                    | 8H: 8 mm hollow shaft<br>14H: 14 mm hollow shaft |  |  |  |  |
| with gearbox | 1-8H<br>1-14H           | 1: 1 Nm                       | 8H: 8 mm hollow shaft<br>14H: 14 mm hollow shaft |  |  |  |  |

<sup>1)</sup> others on request

<sup>2)</sup> standard equipment: 3 plugs / sockets with IO-Link: 1 plug

<sup>3)</sup> Shaft feed-through (solid shaft) IP50, for further information see instruction manual

<sup>4)</sup> only for IO-Link devices

<sup>5)</sup> Available as of Q1/2026



To place your order, please call us at

**+49 7661 3963-0** or email us at







**info@halstrup-walcher.com.**

For additional contacts, please visit

**www.halstrup-walcher.de/en/contact**

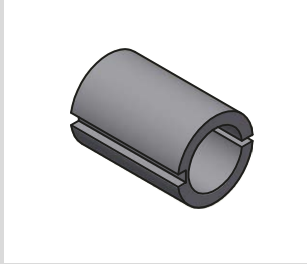
# Accessories for our direct drives

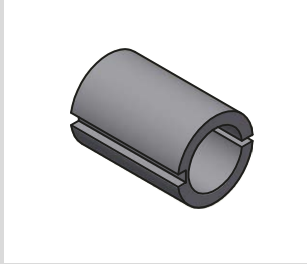
The connectors shown here can be used for all direct drives of the PSD 4xx series. We are happy to help you find the right accessories, please contact us directly.

| Buscommunication | Power supply (+ databus connector) (for option 0) <sup>1)</sup>  | Cable   | Reducing sleeve for adaptation to different spindle diameters  |
|------------------|--|---|--|
| CANopen          |  <p>Connector set: Order no. 9601.0060</p>  | <p>on request</p>  | <p>on request</p>  |
| EtherCAT         |  <p>Connector set: Order no. 9601.0112</p> |                   |                    |
| PROFINET         |  |   |  |
| POWERLINK        |  |   |  |
| EtherNet / IP    |  |   |  |
| IO-Link          |  <p>Connector: Order no. 9601.0107</p>    |   |  |

<sup>1)</sup> see in order code under E

## Software

Use our function blocks, description files or commissioning tools for the various industrial protocols. You can download the files under [www.halstrup-walcher.de/en/software](http://www.halstrup-walcher.de/en/software). To do this, enter your specific product in the drop-down menu that appears and select the Software tab in the tab view. After that, the software components are available to you.

